

LED MIRROR LIGHT

■ Important Safety Instructions:

Basic safety precautions should always be followed when installing, including the following:

1. Read all instructions.
2. Licensed electrician for installation only.
3. Always ensure the power is OFF and the fitting has cooled down before performing any maintenance, cleaning, changing the globe or adjustment to the fitting.
4. Do not install any luminaire near the heat source.
5. Do not exceed the nominal supply voltage or amperage ratings.
6. To avoid injury or damage to the fitting, please ensure that power leads and screws are secure before connecting the power.

■ Installation Procedure

WARNING ⚡

1. Switch off before installation.
2. Switch on only after complete installation and examination of the circuit.
3. Professional electrician for installation and maintenance only.



Turn Off power supply before starting any installation. Read instructions & check you have all the tools & accessories to complete the installation correctly.

■ Installation (1)

Step 1

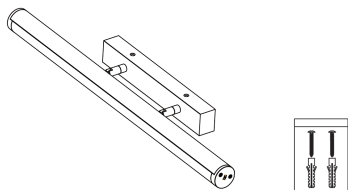

Take out the lamp and accessory pack from box.

Step 2

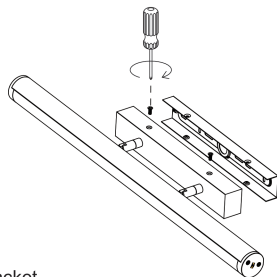

Take out the bracket.

Step 3

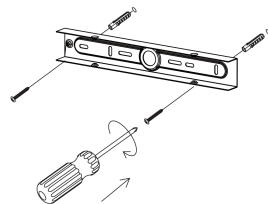

Knock the plastic anchor into ceiling.
Fix bracket with screw on the ceiling.

Step 4

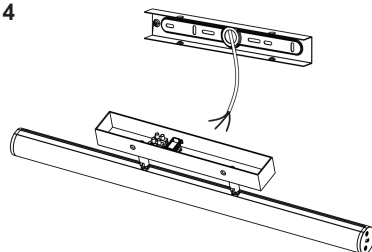

Remove the line pressing clip,
connect the wires correspondingly.

Step 5

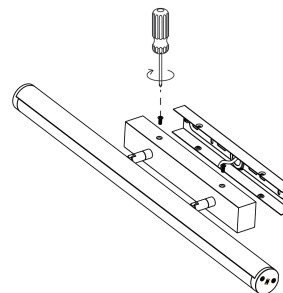

Fix the lamp on the bracket .

Step 6

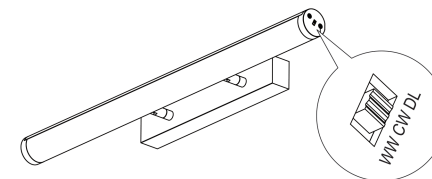

Slide the preferred CCT before turn on the lamp.

Step 7

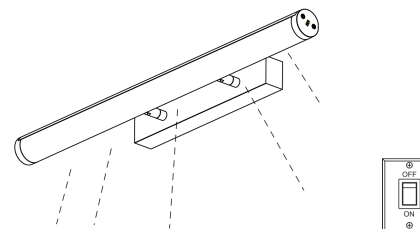

Switch on.

LEUCHTEK GmbH

Am Hopfenbach 12, 22926 Ahrensburg, Deutschland
www.leuchte.de | Tel.: +49 4102 7798707 | info@leuchte.de